

Specification: **BR-1014**

- Super miniature recessed switch
- 1/4" diameter straight cylindrical set for flush or counter sunk installations
- Standard 18" #22AWG leads
- Switch and Magnet available separately
- Wide gap up to 1"+ with 1/4" x 1" rare earth magnet
- Colors: White, Brown, Grey

... Recessed Mounted

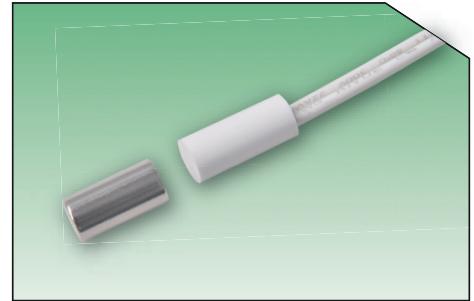

Dimension (mm):

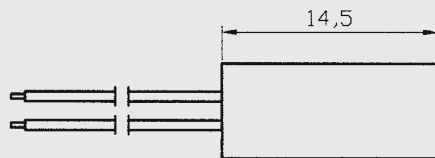

SWITCH

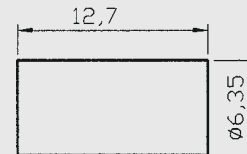

MAGNET

Order Information:

Part Number	Loop Type	Reed Form	Closed Gap [Inch(mm)]	Departure Gap [Inch(mm)]	Maximum Initial Contact Resistance (Ohm)	Maximum Contact Rating (W)	Maximum Switching Voltage (VDC/VAC)	Maximum Switching Current (A)
BR-1014	Closed	N/O	3/4 (19)	0.93(23)	0.150	10	100	0.5